

*CALCULATED WITH TWIN SUZUKI DFI 150'S AND EMPTY TANKS

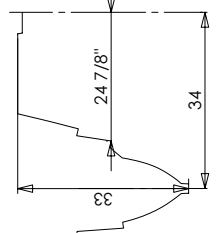
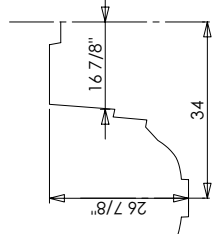
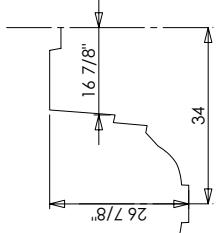
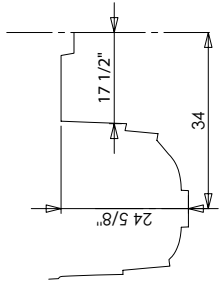

27 SERIES

GLACIER BAY CATAMARANS, LLC
 14288 169TH DRIVE SE
 MONROE, WA 98272
 PHONE: 360-794-0444 FAX: 360-794-6674

TRAILER SECTIONS

DRAWN BY: J. JORGENSEN	DATE: 07/07/08
CHECKED BY:	
PART NO.:	
DRAWING NO.: 000232.000	
FILE: G:\SERIES\27\08\SPECIFICATIONS\TRAILER_SECTION\DRAWING\27 SERIES	

PROPRIETARY MATERIAL. FOR USE BY PERMISSION ONLY.
 GLACIER BAY RESERVES THE RIGHT TO ALTER WITHOUT NOTICE.

REV.	DESCRIPTION	DATE	BY
A		07/07/08	J. JORGENSEN